

## PRACTICE TEST 4 – LISTENING

### SECTION 1: QUESTIONS 1 – 10

Listen to two students talking about libraries in Australia.

#### Questions 1 – 2

Choose the correct letter from **A – D** for each answer.

**Example:** Why is Yumi worried?

- A** She's a new student.
- B** She doesn't know very much about libraries.
- C** She hasn't used a library much.
- D** She has a lot of assignments.

**ANSWER: B**

- 1 Who advised Yumi to join the local library?
  - A** her tutor
  - B** Mary Ann's tutor
  - C** the librarian
  - D** Mary Ann and Yumi's flatmate
  
- 2 What items cannot be borrowed from the local library?



**A**



**B**



**C**



**D**

#### Questions 3 – 4

Choose the correct letter from **A – C** for each answer.

- 3 If Yumi returns a book two days after the loan period has ended,
  - A** she will have to pay a fine.
  - B** she will have to pay 10 cents.
  - C** it won't cost her anything.
  
- 4 Why hasn't Yumi been to the university library yet?
  - A** She couldn't attend the orientation activities.
  - B** She has been sick all week.
  - C** She had to go to her lecture.

**Questions 5 – 9**

Label the map of the library below.  
Choose the correct letter from **A – E** for each answer.

- 5 Returns Box .....
- 6 Library Computers .....
- 7 Monograph Collection .....
- 8 Reference Section .....
- 9 Advisors' Desk .....

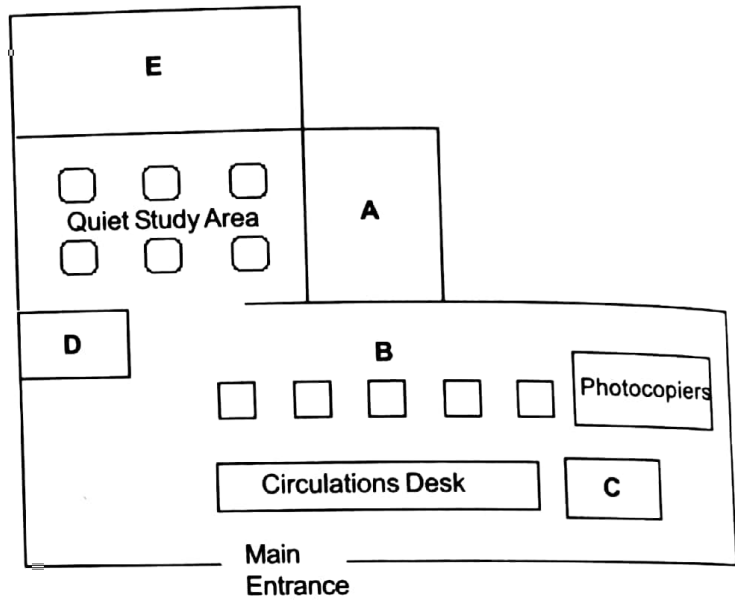

**Question 10**

Complete the sentence below.  
Use **NO MORE THAN THREE WORDS** for your answer.

- 10 Yumi should borrow Recommended Texts from the library as soon as possible because .....

**SECTION 2: QUESTIONS 11 – 20**

**Questions 11 – 16**

Complete the notes below.  
Use **NO MORE THAN THREE WORDS OR A NUMBER** for each answer.

**INTERNATIONAL DRIVING LICENSES**

**FACTS:**

- have been used (11) .....
- drivers do not have to speak the native tongue of the country they are visiting
- drivers must be at least 18 years of age
- drivers must hold a driving license in their home country

**SPECIFICATIONS OF BOOKLET:**

Size of license: 10.8 x (12) ..... cm

Number of pages: 17

Colour of inside pages: (13) .....

Has a photograph of the driver and his/her (14) .....

Available from authorized travel agencies and the (15) .....

Cost of 3 year license: (16) .....

**Questions 17 – 20**

Complete the summary of International Driving Licenses below.  
Use **NO MORE THAN THREE WORDS** for each answer.

International Driving Licenses cannot be used in the (17) ..... . They may only be used in some countries for (18) ..... . Drivers using International Driving Licenses must obey the (19) ..... of the country that they are driving in. The driver must be responsible for learning the rules of the host country, because if they break the rules, they may be (20) ..... .

**SECTION 3: QUESTIONS 21 – 30****Questions 21 – 24**

Complete the chart below.

Match the advantages of joining a learning circle (I – VI) to the person.

**NOTE: there are more advantages listed than you will need.**

Reasons for joining a learning circle given by:	
Economics tutor	(21) .....
Hamish	(22) .....
	(23) .....
Anita	(24) .....

**Advantages of a learning circle**

- I** commits to other students with a shared purpose
- II** can provide motivation to study
- III** commits time to study
- IV** can provide help with understanding subject material
- V** can provide support for other students
- VI** saves the cost of an expensive tutor

**Questions 25 – 27**

Choose the correct letter from **A – C** for each answer.

- 25** The purpose of studying past exam papers is to
- A** do well in the end of term exam.
  - B** contribute to the learning circle.
  - C** compare answers of past papers with other students.
- 26** By doing mock tutorials in the learning circle, the students hope to
- A** practise by themselves first.
  - B** help each other by giving practical advice.
  - C** gain self-confidence.
- 27** Hamish advises Anita to
- A** make a list of objectives for the first learning circle.
  - B** commit to the learning circle and then get a tutor.
  - C** trial the learning circle first.

**Question 28**

Choose the correct letter from **A – D**.

- 28** When was/is the first learning circle study session?
- A** last week
  - B** next week
  - C** Thursday, 6<sup>th</sup> August
  - D** this evening

**Questions 29 – 30**

Choose **TWO** letters from **A – E**.

- 29 & 30** Which two activities are most likely to be discussed at the next learning circle?
- A** past exam papers
  - B** learning styles
  - C** lecture notes
  - D** reading comprehension
  - E** how to re-write lecture notes

**SECTION 4: QUESTIONS 31 – 40**

**Questions 31 – 32**

Complete the notes below.

Use **NO MORE THAN THREE WORDS** for each answer.

Reasons given for speaker adopting wind-generating power:

- lives on a windy farm
- electricity not supplied by (31) .....
- diesel and petrol generators' lack of efficiency and excessive (32) .....

**Questions 33 – 36**

Complete the time-line below.

Use **NO MORE THAN THREE WORDS OR A NUMBER** for each answer.

1975	- speaker bought farm - relied on diesel and petrol generators
late 1975	- Hybrid system installed - successful even in (33) .....
(34) .....	- stopped operating (35) ..... and relied solely on wind generator  - imported four wind generators from the (36) ..... who now supply 50% of world's wind turbines
last year	- bought 600-kilowatt wind turbine

**Questions 37 – 39**

Look at the picture of wind turbines below and complete the following information in the table below.

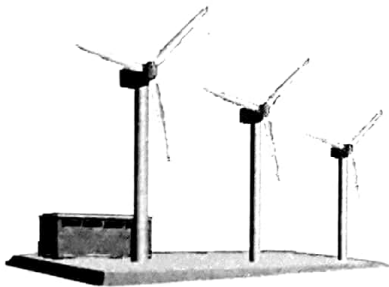

Details of a 600-kilowatt wind turbine given by the speaker	
(37) .....	46 metres
Diameter of rotors:	43.5 metres
Power output:	(38) ..... kilowatt hours per year
Life expectancy:	20 years
Maintenance:	(39) ..... a year

**Question 40**

Complete the notes below.

Use **NO MORE THAN THREE WORDS** for your answer.

40 Possible sources of future income for the speaker include:

- tourists visiting the "wind farm"
- ..... to State Electricity Commission.

