

Test 2

LISTENING

SECTION 1 Questions 1-10

Questions 1-5

Complete the table below.

Write **NO MORE THAN THREE WORDS OR A NUMBER** for each answer.

Programme of Activities for First Day		
Time	Place	Event
<i>Example</i> 10.00	1	Meet the Principal and staff
10.15		Talk by 2.....
10.45		Talk by 3.....
4.....	Classroom 5	5.....test

Questions 6-10

Label the rooms on the map below.

Choose your answers from the box below and write them next to questions 6-10.

CL	Computer Laboratory
DO	Director's Office
L	Library
MH	Main Hall
S	Storeroom
SAR	Self Access Room
SCR	Student Common Room
SR	Staff Room

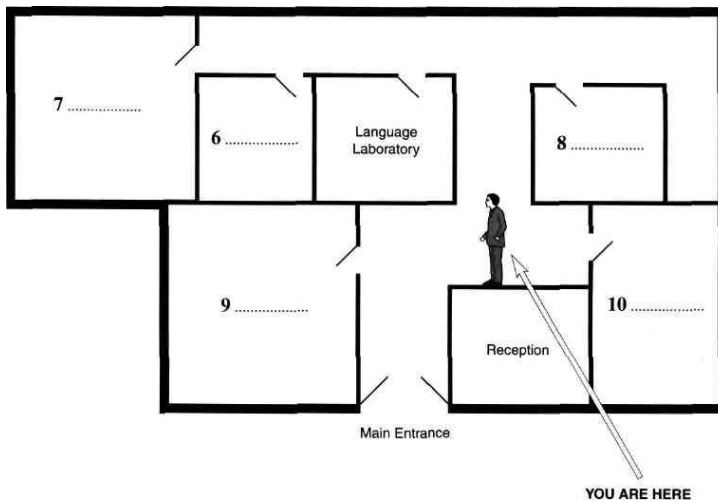

SECTION 2 *Questions 11-20*

Questions 11-15

Complete the table below.

Write **NO MORE THAN THREE WORDS** for each answer.

TYPE OF HELP	EXAMPLES
FINANCIAL	<ul style="list-style-type: none">• grants• 11
12	<ul style="list-style-type: none">• childcare• nurseries
ACADEMIC	<ul style="list-style-type: none">• 13• using the library
14	<ul style="list-style-type: none">• individual interests• 15

Questions 16-20

Complete the notes below.

Write **NUMBERS OR NO MORE THAN THREE WORDS** for each answer.

HELPLINE DETAILS	
Officer	Jackie 16
Address	Student Welfare Office 13 Marshall Road
Telephone number	17
Opening hours	9.30am – 6pm (weekdays) 18 (Saturdays) Ring or visit office for 19
	N.B. At peak times there may be a 20

SECTION 3 *Questions 21-30*

Questions 21-24

Choose the correct letters A-C.

- 21** At the start of the tutorial, the tutor emphasises the importance of
- A** interviews.
 - B** staff selection.
 - C** question techniques.
- 22** An example of a person who doesn't 'fit in' is someone who
- A** is over-qualified for the job.
 - B** lacks experience of the tasks set.
 - C** disagrees with the rest of the group.
- 23** An important part of teamwork is having trust in your
- A** colleagues' ability.
 - B** employer's directions.
 - C** company training.
- 24** The tutor says that finding out personal information is
- A** a skill that needs practice.
 - B** avoided by many interviewers.
 - C** already a part of job interviews.

Questions 25-29

Complete the notes below.

Write **NO MORE THAN THREE WORDS** for each answer.

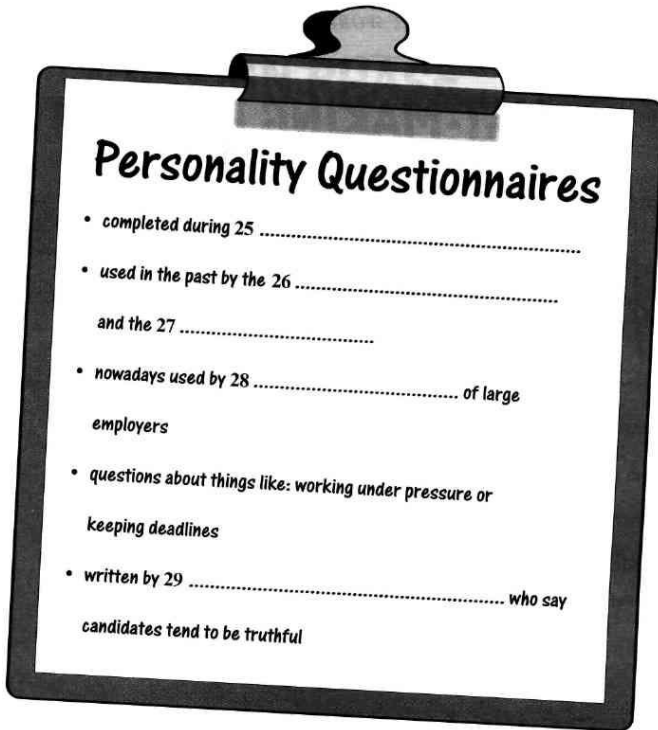

Question 30

Choose the correct letter A—C.

What is the tutor trying to do in the tutorial?

- A describe one selection technique
- B criticise traditional approaches to interviews
- C illustrate how she uses personality questionnaires

SECTION 4 *Questions 31-40*

Questions 31 and 32

Complete the notes below.

Write **NO MORE THAN THREE WORDS AND/OR A NUMBER** for each answer.

HAT-MAKING PROJECT

Project Profile

Example	Answer
Name of student:	Vivien
Type of school: 31	
Age of pupils: 32	

Questions 33 and 34

Label the diagrams.

Write **NO MORE THAN THREE WORDS** for each answer.

Introduction to Hat-Making

First Hat

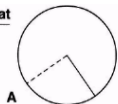

Conical hat



cut into centre and 33.....the cut

Second Hat

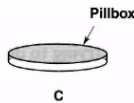
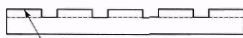
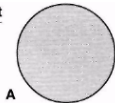

stick flaps to 34.....of circle

Questions 35-37

Complete the notes below.

Write **NO MORE THAN THREE WORDS** for each answer.

DESIGN PHASE

Stage A Refer to research and design a hat 35

Stage B Make a small-scale 36 hat

Constraints

- material: paper
- colours: 37
- glue: must not show

Questions 38-40

Indicate who made the hats below. Write the appropriate letter A-E next to each name.

38 Theresa.....

39 Muriel.....

40 Fabrice.....

